



Approved

Commissioners Court

MAR 9 2015

Johnson County Precinct # 3

Commissioner Jerry D. Stringer

10420 FM 917 Alvarado, Texas 76009

Office: 817-790-5333 FAX: 817-790-3393

Website: www.JohnsonCountyTx.org/Pct3

March 9, 2015

Mr. Ricardo Gonzales, P.E.
Director of Maintenance
Fort Worth Division
Texas Department of Transportation
2501 S. W. Loop 820
Fort Worth, TX 76133

Good morning!

This letter is a follow up to our conversation a few weeks ago regarding the County Transportation Infrastructure Fund Grant Program in Johnson County. The grant funds we applied for were to be allocated between the four Commissioners to be used on approved projects within our precincts.

Johnson County has completed the four projects submitted under the original application that were allocated for Precinct #3 and has been reimbursed by TxDOT. The projects were completed under the proposed budgets set for them, which should allow us to submit one or more additional projects to use the unused reimbursement. It is my request that we be allowed to update our list of projects to add the following project to our grant program:

PROJECT: West Bethesda Road from South Briaroaks Road to Tarver Road
SCOPE OF WORK: Full depth reconstruction, cement stabilization, addition of road base as needed, prime, and chipseal
PROPOSED CONSTRUCTION COST: \$ 101,272.00
ESTIMATED REIMBURSEMENT (@ 90%): \$ 91,145.00

Attached is an updated SB1747 Prioritized Project List, Certification Forms 1 and 2 for the project, a map showing the location, and the proposed scope of activity and budget.

In addition, all required paperwork has been approved by the Johnson County Commissioners Court as indicated by the County Judge's signature below.

Thank you for all assistance in this matter.



Jerry Stringer, Commissioner



Roger Harmon, County Judge 3-9-15

County Name Johnson

CERTIFICATION FORM 1

County Transportation Infrastructure Fund Grant Program

By submitting this form, signed and dated by an authorized representative of the county, the county certifies to TxDOT each item indicated below.

Please mark the appropriate certification block(s) below, sign and date the form, include attachments as noted and deliver to TxDOT's designated district representative.

Within 30 Days after Execution of Grant Agreement with TxDOT

- County Signature Authority** — County Commissioners Court has adopted the attached resolution authorizing county employee(s) signature authority for this program. (attach resolution)
- Define Design Criteria and Specifications** — County certifies design standards, specifications and quality assurance requirements have been adopted for projects under this program. (no attachment required)
- List of Transportation Infrastructure Projects** — County has developed the attached List of Transportation Infrastructure Projects for all projects to be performed with the funds awarded. (attach List of Transportation Infrastructure Projects)
- Reimbursement of Funds** — County certifies reimbursement requests under this program will be prepared following generally accepted cost accounting practices and the Texas Uniform Grant Management Standards. (no attachment required)

Periodic Requirements

Reimbursement Requests (Monthly when charges occur):

- Billing** — County shall submit billing statements including certification of work performed and copies of all paid invoices and/or force account documentation for eligible and not previously submitted expenses. (attach billing statement)

Schedule Updates (No less than semi-annually):

- List of Transportation Infrastructure Projects** — County has developed an update to the List of Transportation Infrastructure Projects for all projects reflecting the current estimated development timeline for all funded projects. (attach updated List of Transportation Infrastructure Projects)
- List of Transportation Infrastructure Projects** — There are no material changes to the most recently submitted List of Transportation Infrastructure Projects. (no attachment required)

County Authorized Representative Signature

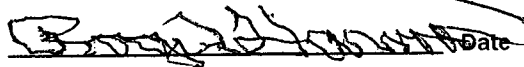

Date 03/09/2015

County Authorized Representative Name

Roger Harmon

Title

County Judge

Counties are required to keep all program and project records related to the County Transportation Infrastructure Fund Grant Program for three years from its receipt of final payment from TxDOT.

CERTIFICATION FORM 2

County Transportation Infrastructure Fund Grant Program

By submitting this form, signed and dated by an authorized representative of the county, the county certifies to TxDOT each item indicated below.

Please mark the appropriate certification block(s) below, sign and date the form, include attachments as noted and deliver to TxDOT's designated district representative.

Prior to Starting Construction on a Project

- Acquisition of Right of Way and Real Property Acquisition** — County certifies it has all required right of way or has obtained all necessary right of entry for performance of this project. County also certifies all right of way acquired for this project since award of County Transportation Infrastructure Fund Grant has been in accordance with applicable requirements of Title II and Title III of the Uniform Relocation Assistance and Real Property Acquisition Policies Act of 1970, Title 42 U.S.C.A., Section 4601 et seq. (no attachment required)
- Relocation of Utilities** — County certifies all impacted utilities have been relocated and identified on the plans. (no attachment required)
- Environmental Permitting and Regulatory Issues** — County has obtained written certification by a qualified professional that an appropriate level of environmental investigation and analysis has been performed for this project, all identified environmental problems have been remediated, and all required permits and clearances from appropriate regulatory agencies have been obtained. (attach certification)
- Compliance with Texas Accessibility Standards and ADA** — County certifies the plans for the transportation infrastructure project are in compliance with applicable Texas Accessibility Standards (TAS) issued by the Texas Department of Licensing and Regulation, under the Architectural Barriers Act, Texas Government Code, Chapter 469. TAS establishes minimum accessibility requirements to be consistent with minimum accessibility requirements of the Americans with Disabilities Act, Title 42 U.S.C., Section 12101 et seq. (no attachment required)
- Material Testing** — County certifies it will follow adopted quality assurance requirements during construction. (no attachment required)

County-Performed Work

- Self-performed Design** — County certifies no engineering, architectural or surveying consultants have been or will be used in performance of this project. (no attachment required)
- Self-performed Construction** — County certifies all maintenance and construction work on this project will be performed with county personnel and work will be performed in accordance with adopted design standards, specifications and quality assurance requirements. (no attachment required)

Contracted Work

- Selection of Engineering, Architectural and Surveying Consultants** — County certifies procurement of engineering, architectural and surveying consultants have followed and will follow applicable state qualifications-based selection procedures. (no attachment required)
- Construction Documents** — County has obtained written certification from a Texas Registered Professional Engineer that the construction documents were developed using the selected/adopted design criteria and specifications. (attach certification)
- Advertisement for Construction Work** — County certifies it has followed and will follow state-required advertisement laws and regulations applicable to construction projects. (no attachment required)
- Construction Contract Procurement** — County certifies it has followed and will follow state laws and regulations applicable to procurement and selection of a construction contractor for this project. (no attachment required)

County Authorized Representative Signature  Date 03/09/2015

County Authorized Representative Name Roger Harmon Title County Judge

Counties are required to keep all program and project records related to the County Transportation Infrastructure Fund Grant Program for three years from its receipt of final payment from TxDOT.

SB 1747 Prioritized Project List

Fill out the following table to the best of your knowledge. Make sure to prioritize your County's projects and put them in order of most importance to least importance. Total project cost will equal the total grant as reflected in the Application and will include Engineering, Right-of-Way and Utility costs, Construction, Inspection, etc.

County is an "economically disadvantaged county" as determined by Transportation Code 222.053.
 NOTE: A list of FY 2014 Economically Disadvantaged Counties was provided for in the notice of the request for applications sent by TxDOT to each county, and can also be found at <http://ftp.dot.state.tx.us/pub/txdot/info/energy/edc-2014.pdf>.

County: JOHNSON
 Choose your county from drop down menu

TxDOT District: Fort Worth

Project Number	Roadway Name or Designation	Project Limits	PROJECT INFORMATION		EXISTING ROADWAY			IMPLEMENTATION SCHEDULE			ESTIMATE				FUNDING	
			Scope / Type of Work	Type of Facility	Existing Surface	Competitive Bid or County Forces?	Proposed Begin Construction Date (Mo./Yr.)	Proposed End Construction Date (Mo./Yr.)	Engineering	ROW/Utilities	Construction	Estimated Total Project Cost	State Share	County Share		
Ex.#1	CR 2	From Main Street to 2 miles East of Driller Drive	2" Overlay and spot base repair	2-lane Rural	Asphalt	Competitive Bid	09/2014	06/2015	\$ 50,000	\$ 20,000	\$ 1,680,000	\$ 1,750,000	\$ 1,575,000	\$ 175,000		
Ex.#2	CR 1041	From SH 37 to CR 1051	Add gravel and re-grade county road due to heavy truck use	2-lane Rural	Un-surfaced	County Forces	05/2014	07/2014	\$ -	\$ -	\$ 250,000	\$ 250,000	\$ 225,000	\$ 25,000		
Your County's Prioritized Project List:																
1	Pennington Crossing - Pct 1	FM 1434 to Westshore	Add gravel, regrade, oil county road due to heavy truck use	2-lane Rural	Gravel	County Forces	05/2014	06/2014	\$ -	\$ -	\$ 12,500	\$ 12,500	\$ 11,250	\$ 1,250		
2	CR 1020 (1) - Pct 2	From CR 920 to CR 914	New construction .8 miles	2-lane Rural	Chip Sealed	County Forces	04/2014	04/2014	\$ -	\$ -	\$ 18,344	\$ 18,344	\$ 16,510	\$ 1,834		
3	CR 606 - Pct 3	From CR 531 to CR 529	Partial reclamation, add road base, chip seal entire road	2-lane Rural	Chip Sealed	County Forces	05/2014	06/2014	\$ -	\$ -	\$ 57,962	\$ 57,962	\$ 52,166	\$ 5,796		
4	CR 801B (1) - Pct 4	North of Loop 67 to CR 701, 1.3 miles	Reclaim current roadway, add 6" of road base, and chip seal surface with 2 applications of CRS, 2 and rock	2-lane Rural	Chip Sealed	County Forces	05/2014	09/2014	\$ -	\$ -	\$ 80,097	\$ 80,097	\$ 72,087	\$ 8,010		
5	CR 905 - Pct 1	From CR 1010 to CR 1017	Seacoat from CR 1010 north 1 mile; gravel 0.8 mile due to heavy truck use	2-lane Rural	1 mile Asphalt, 0.8 un-surfaced	County Forces	06/2014	07/2014	\$ -	\$ -	\$ 21,486	\$ 21,486	\$ 19,337	\$ 2,149		
6	CR 1020 (2) - Pct 2	From CR 920 to CR 914	Level up .248 miles	2-lane rural	Chip Sealed	County Forces	04/2014	04/2014	\$ -	\$ -	\$ 26,606	\$ 26,606	\$ 23,945	\$ 2,661		
7	Jessica Dr - Pct 3	From FM 917 to Hanks St	Partial reclamation, add road base, spot level up, chip seal entire road	2-lane Rural	Chip Sealed	County Forces	05/2014	06/2014	\$ -	\$ -	\$ 104,388	\$ 104,388	\$ 93,949	\$ 10,439		
8	CR 411 - Pct 4	From CR 316 to CR 405 .9 miles	Reclaim current roadway, add 6" of road base, and chip seal surface with 2 applications of CRS, 2 and rock	2-lane Rural	Chip Sealed	County Forces	05/2014	09/2014	\$ -	\$ -	\$ 60,000.00	\$ 60,000.00	\$ 54,000.00	\$ 6,000.00		
9	CR 904 - Pct 1	From CR 1010 to CR 1022	Regrade, asphalt due to heavy traffic	2-lane Rural	Asphalt	County Forces	06/2014	07/2014	\$ -	\$ -	\$ 79,750	\$ 79,750	\$ 71,775	\$ 7,975		
10	CR 914 - Pct 2	From CR 1016 to CR 1021	Hot mix, .140 miles	2-lane Rural	Chip Sealed	County Forces	04/2014	04-2014	\$ -	\$ -	\$ 14,880	\$ 14,880	\$ 13,392	\$ 1,488		
11	Willow Lane - Pct 3	From E. Renfro to Noe Ln.	Reclamation, add road base, chip seal entire road	2-lane Rural	Chip Sealed	County Forces	06/2014	06/2014	\$ -	\$ -	\$ 25,553	\$ 25,553	\$ 22,998	\$ 2,555		
12	CR 213 - Pct 4	From FM 1807 north to Hwy 67, 2.8 miles	Reclaim current roadway, add 6" of road base, and chip seal surface with 2 applications of CRS, 2 and rock	2-lane Rural	Chip Sealed	County Forces	05/2014	09/2014	\$ -	\$ -	\$ 186,890	\$ 186,890	\$ 168,201	\$ 18,689		
13	CR 1009 - Pct 1	From FM 917 to SH 171	Re-grade, asphalt due to heavy traffic	2-lane Rural	Asphalt	County Forces	07/2014	08/2014	\$ -	\$ -	\$ 79,500	\$ 79,500	\$ 71,550	\$ 7,950		
14	CR 1016 - Pct 2	From CR 921 to FM 1902	Level up 1.2 miles	2-lane Rural	Chip Sealed	County Forces	05/2014	05/2014	\$ -	\$ -	\$ 136,184	\$ 136,184	\$ 122,566	\$ 13,618		

15	CR 608 - Pct 3	From FM 917 to CR 519	Partial reclamation, add road base, replace culvert, pour headwalls, chip seal entire road	2-lane Rural	Chip Sealed	County Forces	06/2014	07/2014	\$ -	\$ -	\$ 97,398	\$ 97,398	\$ 97,398	\$ 87,658	\$ 9,740
16	CR 801B (2)- Pct 4	South of Loop 67 to CR 895, .9 miles	Reclaim current roadway, add 6" of road base, and chip seal surface with 2 applications of CRS-2 and rock	2-lane Rural	Chip Sealed	County Forces	04/2015	10/2015	\$ -	\$ -	\$ 59,584	\$ 59,584	\$ 53,626	\$ 5,958	
17	CR1230 - Pct 1	FM 4 to FM 1434	Re-grade, asphalt due to heavy traffic	2-lane Rural	Asphalt	County Forces	08/2014	09/2014	\$ -	\$ -	\$ 111,875	\$ 111,875	\$ 100,688	\$ 11,188	
18	CR 921 - Pct 2	From CR 1016 to John Jones Rd	Level up .248 miles	2-lane Rural	Chip Sealed	County Forces	06/2014	06/2014	\$ -	\$ -	\$ 26,596	\$ 26,596	\$ 23,936	\$ 2,660	
19	CR 1250 - Pct 1	FM 2331 to End	Re-grade, asphalt due to heavy traffic	2-lane Rural	Asphalt	County Forces	09/2014	10/2014	\$ -	\$ -	\$ 32,480	\$ 32,480	\$ 29,232	\$ 3,248	
20	CR 919-N - Pct 2	CR 920 to Camaro Dr.	Level Up .062 miles	2-lane Rural	Chip Sealed	County Forces	07/2014	07/2014	\$ -	\$ -	\$ 6,650	\$ 6,650	\$ 5,985	\$ 665	
21	CR 1019 - Pct 2	From CR 919 to FM 1902	Level up .175 miles	2-lane Rural	Chip Sealed	County Forces	07/2014	07/2014	\$ -	\$ -	\$ 18,915.00	\$ 18,915.00	\$ 17,024	\$ 1,892	
22	CR 919S - Pct 2	From CR 920 to CR 1016	Level up .155 miles	2-lane Rural	Chip Sealed	County Forces	07/2014	07/2014	\$ -	\$ -	\$ 16,690.00	\$ 16,690.00	\$ 15,021	\$ 1,669	
23	CR 914A - Pct 2	From CR 914 to CR 1016A	Level up .217 miles	2-lane Rural	Chip Sealed	County Forces	07/2014	07/2014	\$ -	\$ -	\$ 23,293.00	\$ 23,293.00	\$ 20,963	\$ 2,329	
24	CR 913E - Pct 2	From FM 1902 to CR 1021	Level up .540 miles	2-lane Rural	Chip Sealed	County Forces	08/2014	08/2014	\$ -	\$ -	\$ 57,261.00	\$ 57,261.00	\$ 51,536	\$ 5,726	
25	CR 1022 - Pct 2	From FM 917 to CR905A	Level up .800 miles	2-lane Rural	Chip Sealed	County Forces	09/2014	09/2014	\$ -	\$ -	\$ 41,152.00	\$ 41,152.00	\$ 37,037	\$ 4,115	
26	W Bethesda - Pct 3	From S. Briar Oaks Rd. to Tarver Rd.	Full reclamation, add road base, cement stabilization, prime and chip seal entire road	2-lane Rural	Chip Sealed	County Forces	06/2015	09/2015	\$ -	\$ -	\$ 101,272.00	\$ 101,272.00	\$ 91,145	\$ 10,127	
													\$ 1,497,306	\$ 1,347,576	\$ 149,731

All boxes will expand automatically if you need more room. Just keep typing and the text will wrap.

These two funding columns are locked and cannot be changed. The percentages are dictated by whether you are an Economically Disadvantaged County or not.

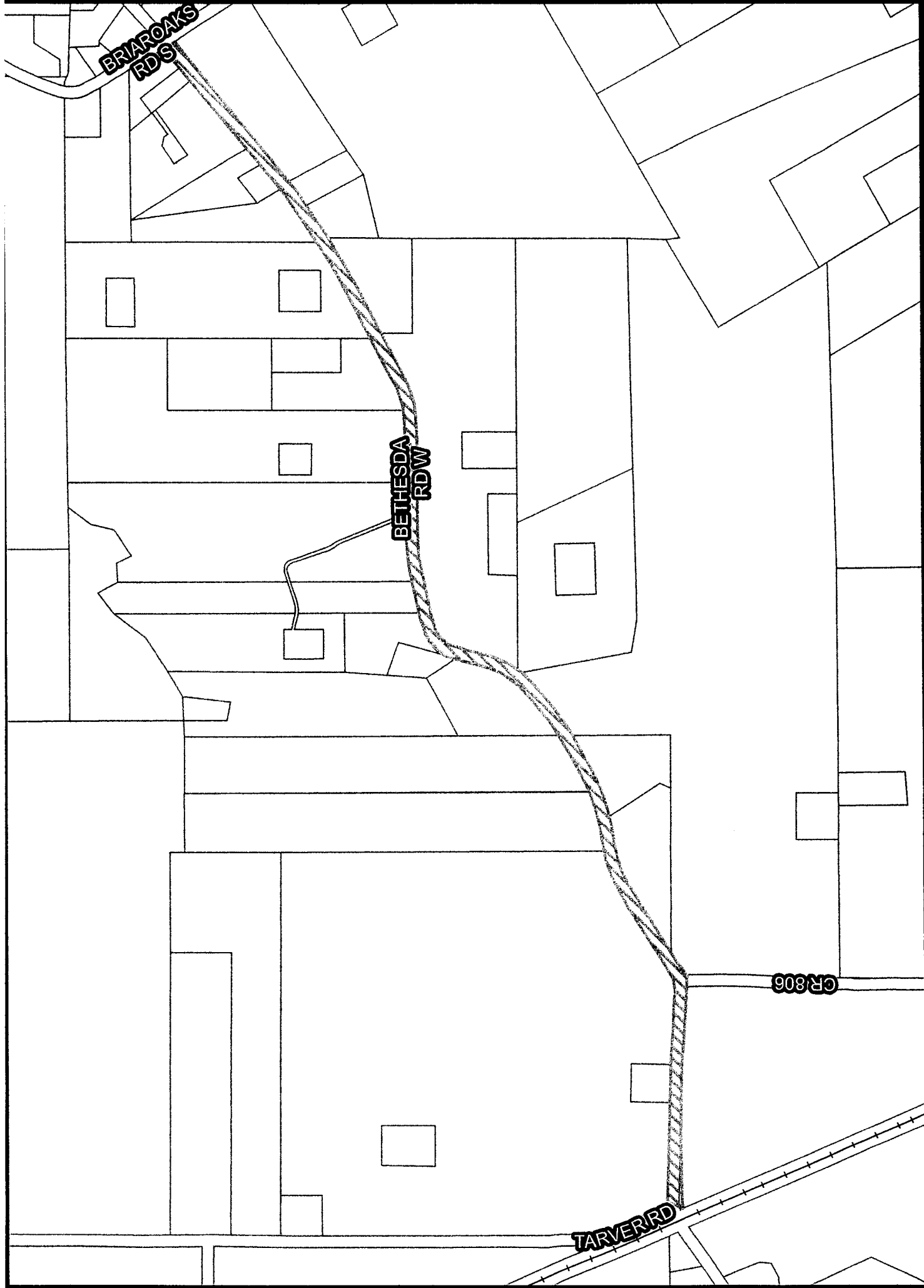

**Johnson County Transportation Project Pct. 3
W. Bethesda Rd (from South Briaroaks Road to Tarver Road)**

1 in = 0.12 miles



JOHNSON COUNTY, TEXAS

SCHEDULE OF COSTS FOR PRECINCT SERVICES

Approved in Commissioners Court on Monday, March 25, 2013

ATTACHMENT A

DATE: 1/26/2015 **DATE QUOTE EXPIRES:** 9/30/2015

TO: Name:
Attn:
Address:
City, State, Zip:

PROJECT: Location of Project West Bethesda (1.3 Miles)
Reclaim from South Briar Oaks Rd. to RxR Tracks at Tarver Rd.
Seal coat

SERVICES: Basic Labor \$23.00 per hour x 8 hours x 2 Men \$368.00

Total Services Cost: **\$368.00**

MATERIALS:	Road Base	\$5.25 per ton	x 3400	tons	\$17,850.00
	Grade #4 Rock	\$18.00 per ton	x 350	tons	\$6,300.00
	Pea Gravel	\$8.00 per ton	x	tons	\$0.00
	MC-30 Prime	\$4.15 per gal.	x 2475.00	gallons	\$10,271.25
	CRS-2 Emulsion	\$2.28 per gal.	x 6,911	gallons	\$15,781.96
	Concrete for Header Walls	\$0.00 per yard	x	yards	\$0.00
	Hot Mix Asphalt	\$58.00 per ton	x	tons	\$0.00
	Culverts (installation only)	\$15.00 per foot	x	feet	\$0.00
	Spreadable Cement	\$120.40 per ton	x 175.00	tons	\$21,070.00
	Spread Fee for Cement	\$300.00 per load	x 7.00	trucks	\$2,100.00
	Signage and Hardware			Total Signage:	
	Over Size Rock 4x8	\$10.50 per ton	x	tons	\$0.00
	Over Size Rock 2x4	\$6.50 per ton	x	tons	\$0.00

Total Materials Cost: **\$73,373.21**

HAULING:	Hauling (Round Trip)	\$0.75 per mile	x	miles	\$0.00
Fuel Surcharge:	FSC up to \$3.75 /gal	\$0.00 per mile	x	miles	\$0.00
(Based on cost to county)	FSC from 3.76 to 4.00 /gal	\$0.05 per mile	x	miles	\$0.00
	FSC from 4.01 to 4.25 /gal	\$0.10 per mile	x	miles	\$0.00
	FSC from 4.26 to 4.50 /gal	\$0.15 per mile	x	miles	\$0.00
	FSC from 4.51 to 4.75 /gal	\$0.20 per mile	x	miles	\$0.00
	FSC from 4.76 to 5.00 /gal	\$0.25 per mile	x	miles	\$0.00

Total Hauling Cost: **\$0.00**

EQUIPMENT: Minimum charge – 2 hours
Truck w/ operator \$59.50 per hour x 10 hours x 6 \$3,570.00

Loader w/ operator

\$66.00 per hour x

10

hours

x

1

\$660.00

SCHEDULE OF COSTS FOR PRECINCT SERVICES

ATTACHMENT A (Continued)

Track machine w/ operator	\$105.00 per hour x		hours	x		\$0.00
Durapatcher w/ 2 operators	\$86.00 per hour x		hours	x		\$0.00
Distributor w/ operator	\$86.00 per hour x	6	hours	x	1	\$516.00
Water truck w/ operator	\$59.50 per hour x	80	hours	x	2	\$9,520.00
Backhoe w/ operator	\$59.50 per hour x		hours	x		\$0.00
Roller w/ operator	\$59.50 per hour x	78	hours	x	3	\$13,923.00
Motorgrader w/operator	\$86.00 per hour x	80	hours	x	2	\$13,760.00
Reclaimer w/ operator	\$132.00 per hour x	60	hours	x	1	\$7,920.00
Gradall w/ operator	\$86.00 per hour x		hours	x		\$0.00
Pickups w/ operator	\$33.00 per hour x	80	hours	x	2	\$5,280.00
Chip spreader w/operator	\$86.00 per hour x	6	hours	x	2	\$1,032.00
Broom w/ operator	\$59.50 per hour x	4	hours	x	1	\$238.00
Excavator w/ operator	\$59.50 per hour x		hours	x		\$0.00
Brushcutter w/operator	\$59.50 per hour x		hours	x		\$0.00
Crack Sealer w/operator	\$86.00 per hour x		hours	x		\$0.00
Wood Chipper w/operator	\$86.00 per hour x		hours	x		\$0.00

Total Equipment Cost:

\$56,419.00

Grand Total:

\$130,160.21

NOTES / SPECIAL CONDITIONS

Please Make Checks Payable To:

Johnson County Precinct #3

Please Mail To:

**Johnson County Precinct #3
Attn: Jerry Stringer, Commissioner
10420 FM 917
Alvarado, Tx 76009**